

SAVE VSR 150/B

puldi kaabel 6m

Toote number: 488801

Variant: Pleated Filters Standard kit



Filter kits:

161651 PF STD kit (F7/ePM1 60% supply and M5/ePM10 50% extract)

161652 PF OPT kit (accessory) (F8/ePM1 70% supply and M5/ePM10 50% extract)

Main features:

- High energy-efficiency rotary heat exchanger with EC technology fans
- Demand control regulation with the built-in humidity sensor
- Moisture transfer function to minimize condensation in supply air during wintertime
- Multiple control options to choose from
- Connection board for easy access and connection of accessories
- Modbus communication RS-485 as standard
- Cooker hood connection
- Eurovent Certification

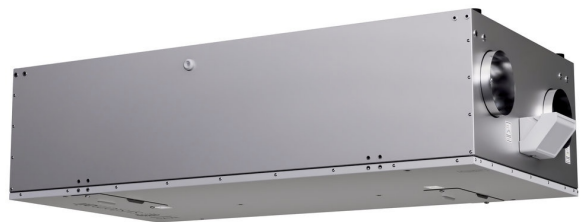

SAVE VSR 150/B is adapted for ventilation of smaller houses and apartments with an area of 100 m². The unit can be mounted on the wall or under the ceiling.

SAVE VSR 150/B has double skinned panels and white painted doors. The unit is equipped with a high efficiency variable speed rotating heat exchanger and a moisture transfer function that regulates the rotation speed of the rotor. Energy efficient fans with EC motors as well as low-pressure filters reduce the energy consumptions and ensures low SFP factor (Specific Fan Power) and sound level. The built-in humidity sensor in extract air can be used for demand control.

A duct from the cooker hood can be connected to a separate bypass duct on the unit, so the air from the cooker hood is led straight to the exhaust fan and not through the heat exchanger in the unit.

Simple filter change via hatches on the door.

The unit can be operated in a variety of ways:

- SAVE LIGHT – control panel for basic functions such as airflow control, general alarm and filter change indication.
- SAVE TOUCH – control panel with touch screen and full access to all functions and settings. The home screen displays information such as airflow, temperature, air quality and active functions. You can select between MANUAL and AUTO mode or select preferred settings from the pre-configured user modes and much more.
- SAVE CONNECT – Home solutions by Systemair mobile application and Internet Access Module for wireless control of the SAVE unit. The mobile application mirrors functionality of SAVE TOUCH control panel and allows you to access all control functions on your smartphone.

Each control method is optional and have to be ordered separately as an accessory. 6 meter cable for the control panel connection to the unit is included with the unit.

The unit comes with a built-in electric reheater.

External connection board that has prewired inputs and outputs allows easy installation and setup of external sensors as well as external heaters / coolers and other accessories.

Tehnilised parameetrid

Seade	
Sagedus	50 Hz
Voltage (nominal)	230 V
Phases	1~
Soovitatav kaitse	10 A
Kaitseklass	IP24
Kiiruse reguleerimine	Pidevtoimeline
Toote tüüp	Heat recovery unit
Eelküte/Järelküte	
Sisendvõimsus, järelkütteseade	0.5 kW
Sissepuhkeventilaator	
Sisendvõimsus (P1) sissepuhkeventilaatorile	37 W
Sisendõhu filter	
Filtri klass, sissepuhkeõhk	ePM1 60%
Väljatõmbeõhu filter	
Filtri klass, väljatõmme	ePM10 50%
Soojusvaheti	
Soojusvaheti rootortüüpi ajam	Muutuva kiirusega
Soojusvaheti	Pöörlevad
Tagastusventilaator / Väljatõmbeventilaator	
Sisendvõimsus, Väljatõmbeventilaator	37 W
Others	
Suurus	150
Ventilaatori reguleerimine	Pidevtoimelise pinge reguleerimine
paigaldamise tüüp	Vahelaed
Sissepuhke pool	parem; vasak
Korpuse värv	
Korpuse värv	Tsingitud teras
Mõõtmed ja kaal	
Kaal	58 kg
ErP	
Energiaklass, Baasseade	A
Energiaklass, kohalik nõue	A
ErP valmidus	ErP 2018; ErP 2016

Jõudlused

Sissepuhe - Tootluse kõver

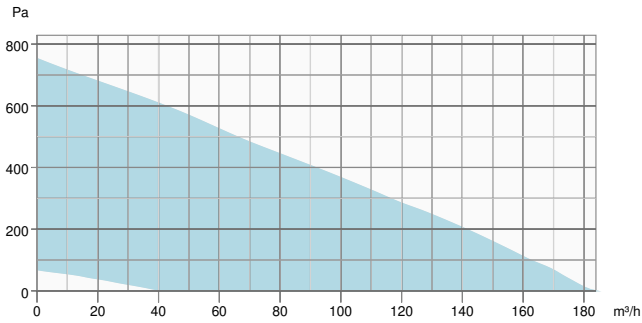

Väljavõte - Tootluse kõver

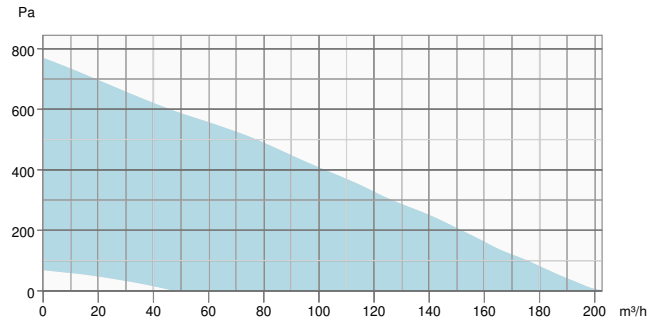

Seade	Sissepuhe	Väljavõte
Vajalik õhuvool	-	-
Töö õhuvool	-	-
Vajalik väline surve	-	-
Töö õhurõhk	-	-
Võimsus	-	-
Ventilaatori juhtimine - RPM	-	-
Soovitatav madal - RPM	-	-
Soovitatav kõrge - RPM	-	-
Ventilaatori juhtimine - %	-	-
Soovitatav madal - %	-	-
Soovitatav kõrge - %	-	-
Air density		1.204 kg/m ³
SFP		-
Sissepuhke õhu temperatuur		-20.0 °C

Helirõhu tase	Kokku
---------------	-------

Soojust taastav	Sissepuhe	Väljavõte
Siseneva õhu temperatuur	-	-
Väljaviske õhu temperatuur	-	-
Siseneva õhu niiskus	-	-
Väljamineva õhu niiskus	-	-
Kondensaat	-	-
Ülekantud elekter	-	-
Temperatuuri kasuteguri ühiku (EN 13141-7)	-	-
Temperatuuri kasuteguri komponent (EN 308)	-	-
Niiskus tõhusus	-	-
Vaheti tüüp	-	-

mõõt

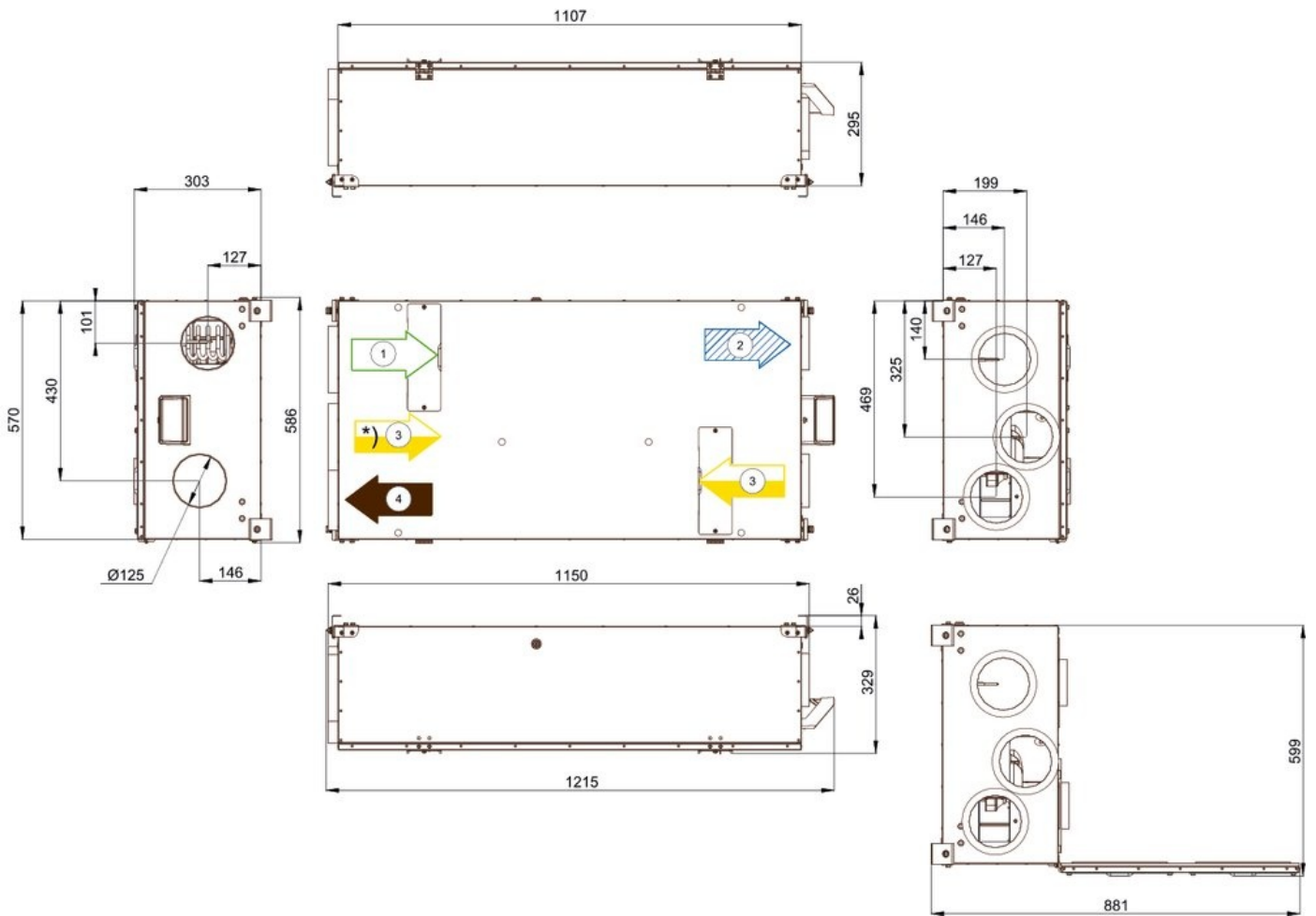

* Connection for cooker hood

- 1 Outdoor air
- 2 Supply air
- 3 Extract air
- 4 Exhaust air

Ökodisaini

Toode	
Ärinimi	Systemair
Toote nimi	SAVE VSR 150/B
Baasseade	
ErP vastavus	2018
SEC Keskmine	-36.1 kWh/(m ² .a)
SEC Külm	-79.1 kWh/(m ² .a)
SEC Soe	-11.5 kWh/(m ² .a)
SEC Klass	A
Seadme kategooria	RVU
Seadme tüüp	BVU
Ajam	Integreeritud VSD
Soojustagastuse tüüp	Taastav
Temperatuuri suhe	85 %
QV max	168 m ³ /h
P max	83 W
Helivõimsuse tase LWA	36 dB(A)
QV ref	0.033 m ³ /s
PS ref	50 Pa
SPI	0.392 W/(m ³ /h)
CTRL	0.85
VARIA	1.1
x-väärtus	2
Väline leke	3 %
Sisemine leke	Pole saadaval
Carry over	4 %
Toote tüüp	RAHU/AARE
AEC keskmine	354 kWh
AEC külm	354 kWh
AEC soe	354 kWh
AHS keskmine	4 494 kWh/a
AHS Külm	8 792 kWh/a
AHS soe	2 032 kWh/a

Seadmed kohaliku vajaduse järgi reguleerimisega

ErP vastavus	2018
SEC Keskmine	-40.7 kWh/(m ² .a)
SEC Külmi	-84.6 kWh/(m ² .a)
SEC Soe	-15.6 kWh/(m ² .a)
SEC Klass	A
Seadme kategooria	RVU
Seadme tüüp	BVU
Ajam	Integreeritud VSD
Soojustagastuse tüüp	Taastav
Temperatuuri suhe	85 %
QV max	168 m ³ /h
P max	83 W
Helivõimsuse tase LWA	36 dB(A)
QV ref	0.033 m ³ /s
PS ref	50 Pa
SPI	0.392 W/(m ³ /h)
CTRL	0.65
VARIA	1.1
x-väärtus	2
Väline leke	3 %
Sisemine leke	Pole saadaval
Carry over	4 %
Toote tüüp	RAHU/AARE
AEC keskmine	207 kWh
AEC külmi	207 kWh
AEC soe	207 kWh
AHS keskmine	4 590 kWh/a
AHS Külmi	8 979 kWh/a
AHS soe	2 075 kWh/a

Energiaklassi silt

Energiaklass, Baasseade

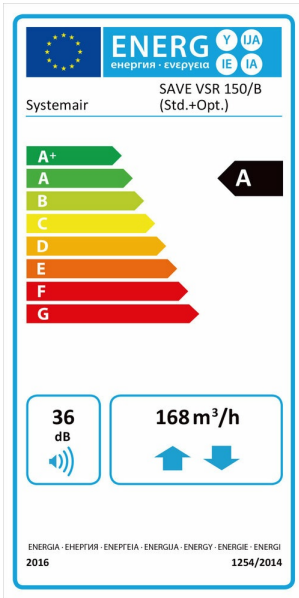

Lisatarvikud

- PF VSR 150 OPT kit 1 (161652)
- SAVE Light must (319119)
- SAVE Touch displei must (138078)
- SAVE VSR 150 F7/M5 STD 190/48 (161651)
- Horizontal mounting kit VSR150 (162999)
- PSS 20 trafo 24V (202692)
- RMK-T (153548)
- SAVE displei seinakinnitus (140736)
- SAVECair CO2 andur (14904)
- SAVECair VAV/CAV komplekt (140777)
- Vertical mounting kit VSR 150 (165599)
- CB 125-1,2 230V/1 kalorifeer (5290)
- CEC kaabel 12m (24782)
- CWK 125-3-2,5 jahutuspatarei (30021)
- Kanaliandur -30-70C (211524)
- LDC 125-900 mürasummuti (5191)
- RS-24V (159484)
- 251-10/B köögikubu valge (12023)
- 602-10/B köögikubu, valge (47561)
- 722-10/B TENDER 600 köögikubu (78978)
- 722-10/B TENDER 900 teras (78977)
- 762-10/B OPAL 900 teras (78971)
- 782-10/B STIL 900 teras (78974)
- 792-10/B STIL 900# (78975)
- Connectduct Ø 125/1,0 M/F (2556)
- CVVX 125 seinaelement, valge (26422)
- MONOLIT - B White köögikubu (326800)
- RVAZ4 24A Ventiiiajam 0-10V (9862)
- TUNE-R-125-3-M1 (311938)
- TUNE-R-125-3-M4 (311968)
- ZTR 15-0,4 3-tee ventiil (9670)
- ZTV 15-0,4 2-tee ventiil (9829)
- SAVE Connect interneti moodul (323606)
- SAVE Light valge (319118)
- SAVE Touch displei valge (138077)
- CO2 kanaliandur SAVE Cair (14906)
- Presence detector/IR24-P (6995)
- RMK relee sulgklappide ühendam (153549)
- Rõhuandur/rõhulüliti 20-200Pa (212987)
- SAVE eelkütte ühenduskompl (142852)
- SAVECair CO2/RH# (211522)
- VBC 125-3 Veeküttekalorifeer (9839)
- CB 125-0,6 230V/1 kalorifeer (5289)
- CB 125-1,8 230V/1 kalorifeer (5377)
- CEC kaabel 6m (24783)
- FK 125 kinnitusklamber (1608)
- LDC 125-600 mürasummuti (5190)
- Pinnaandur -30-150C (211523)
- VBC 125 veekalorifeer, ümar (5457)
- 392-10/B 600 valge (77265)
- 602-10/B pliidikubu (47562)
- 722-10/B TENDER 600 teras (78976)
- 762-10/B OPAL 600 teras# (78970)
- 772-10/B OPAL 900 teras (78972)
- 782-10/B STIL köögikubu (78973)
- CLASSIC - B Valge (326802)
- CVVX 125 seinaelement, must (26421)
- MONOLIT - B S.Steel köögikubu (326801)
- Ruumi temp.andur 0-50C (211525)
- SPI 125 C õhu reguleerklapp (6751)
- TUNE-R-125-3-M2 (311948)
- TUNE-R-125-3-M5 (311978)
- ZTR 15-0,6 3-tee ventiil (6573)
- ZTV 15-0,6 2-tee ventiil (6571)

Spetsifikatsioon

- **Connection board for easy access and connection of accessories**
- **Modbus communication RS-485 as standard**
- **Cooker hood connection**
- **Eurovent Certification**

SAVE VSR 150/B is adapted for ventilation of smaller houses and apartments with an area of 100 m². The unit can be mounted on the wall or under the ceiling.

SAVE VSR 150/B has double skinned panels and white painted doors. The unit is equipped with a high efficiency variable speed rotating heat exchanger and a moisture transfer function that regulates the rotation speed of the rotor. Energy efficient fans with EC motors as well as low-pressure filters reduce the energy consumptions and ensures low SFP factor (Specific Fan Power) and sound level. The built-in humidity sensor in extract air can be used for demand control.

A duct from the cooker hood can be connected to a separate bypass duct on the unit, so the air from the cooker hood is led straight to the exhaust fan and not through the heat exchanger in the unit.

Simple filter change via hatches on the door.

The unit can be operated in a variety of ways:

- **SAVE LIGHT** – control panel for basic functions such as airflow control, general alarm and filter change indication.
- **SAVE TOUCH** – control panel with touch screen and full access to all functions and settings. The home screen displays information such as airflow, temperature, air quality and active functions. You can select between MANUAL and AUTO mode or select preferred settings from the pre-configured user modes and much more.
- **SAVE CONNECT** – Home solutions by Systemair mobile application and Internet Access Module for wireless control of the SAVE unit. The mobile application mirrors functionality of SAVE TOUCH control panel and allows you to access all control functions on your smartphone.

Each control method is optional and have to be ordered separately as an accessory. 6 meter cable for the control panel connection to the unit is included with the unit.

- **Multiple control options to choose from**
- **Moisture transfer function to minimize condensation in supply air during wintertime**
- **Demand control regulation with the built-in humidity sensor**
- **High energy-efficiency rotary heat exchanger with EC technology fans**

Main features:

161652 PF OPT kit (accessory) (F8/ePM1 70% supply and M5/ePM10 50% extract)

161651 PF STD kit (F7/ePM1 60% supply and M5/ePM10 50% extract)

Filter kits:

The unit comes with a built-in electric reheater.

External connection board that has prewired inputs and outputs allows easy installation and setup of external sensors as well as external heaters / coolers and other accessories.